

CYB-K2812**Erişim Kontrol Sistemi**

CYB-K2812 access controller is designed with latest structure with TCP/IP communication interface. The communication data is encrypted to improve the security of system. The controller also supports offline operation and is designed with tamper-proof switch.

- ▣ Supports two doors access control Supports multi-door interlocking function, anti-passback
- ▣ function, multi-card function, first person function, super card and super password function
- ▣ Supports alarm event upload Supports RS-485 interface and Wiegand interface for accessing card reader. Wiegand interface supports
- ▣ W26/W34 and is seamlessly compatible with third-party card reader with Wiegand interface
- ▣ Supports standby battery Data can be saved when the access controller is powered off

□ Specification

Network		Wired
network	Interface	10 M/100 M self adaptive
Network interface		
Lock control	Exit button	1
Door contact		2
Alarm input		2
Alarm output	TAMPER	2
RS-485		5
Wiegand		4
Capacity Card capacity		1
Event capacity		1
General Power supply		4, Wiegand 26/34
Battery		
Power consumption		10,000
		50,000
Working temperature		
Working humidity		100 to 240 VAC
Dimensions		Backup battery connection available
		With load: ≤ 100 w
		Without load: ≤ 4 w
		-20 °C to 65 °C (-4 °F to 149 °F)
		10% to 90% (no condensing)
		370 mm × 345 mm × 90 mm (14.6" × 13.6" × 3.5")

□ Typical Application

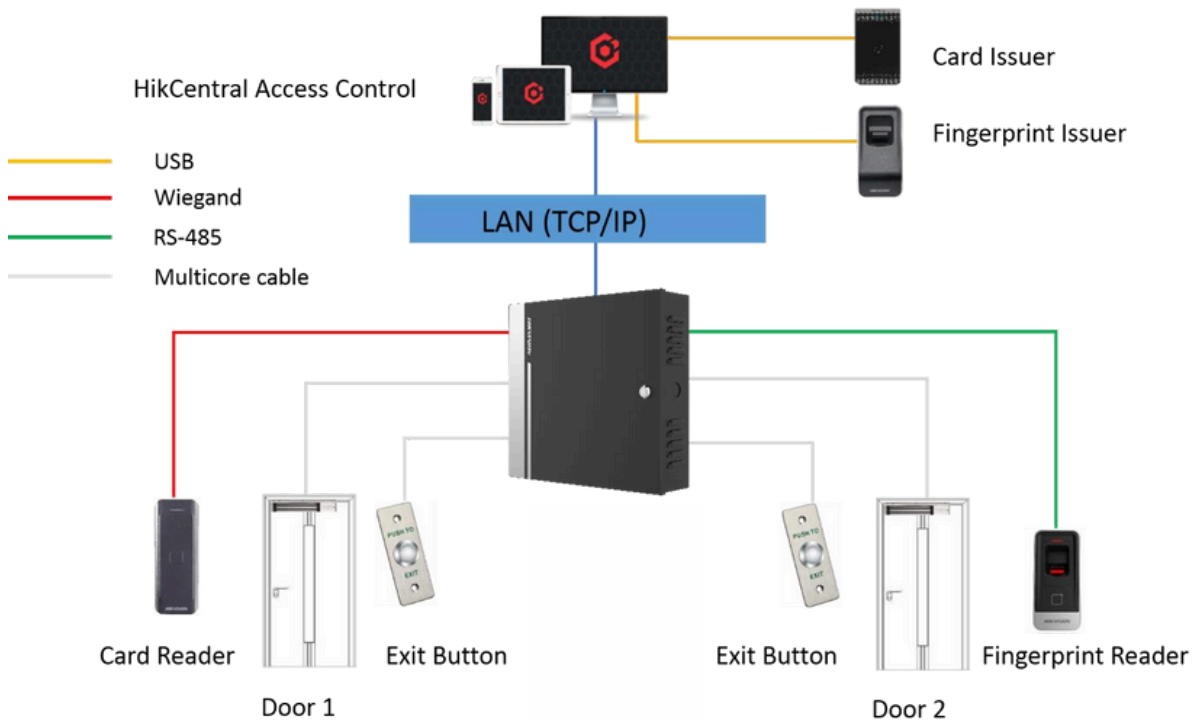

□ **Available Model**
CYB-K2812

□ **Dimension**

